

ZERO TANGENT™ Radius Flat Top

	in	mm
Row to Row Angle	1.33 degrees	
Maximum Width	55.12	1400
Minimum Width	7.87	200
Width Increments	7.87	200
Open Area	0%	
Hinge Style	Closed	
Drive Method	Center/Hinge-Driven	

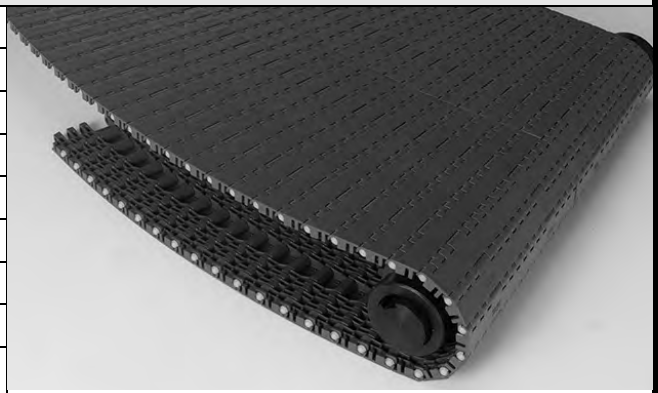

Product Notes

- **Contact Intralox for precise belt measurements and stock status before designing equipment or ordering a belt.**
- Designed for radius applications with a minimum inside turn radius of 23.62 in (600 mm).
- Belt shape requires zero straight sections before and after turn.
- Pitch distance changes depending upon location of module from center of turn.
- Complete design guideline packages supplied to minimize engineering design investment.
- Row to row angle is nominally 1.33 degrees around center of turn.
- Uses headless rods.

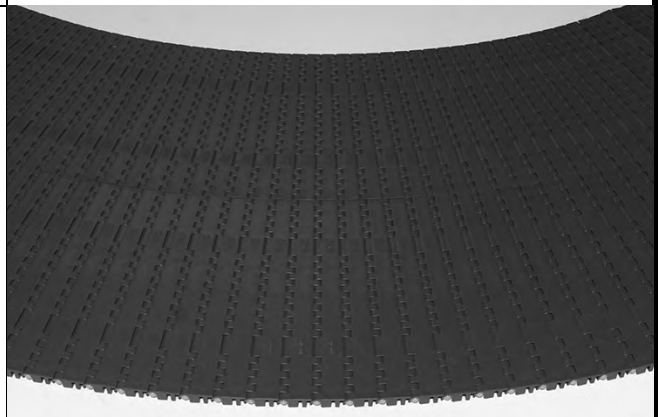

Additional Information

- See "Belt Selection Process" (page 7)
- See "Standard Belt Materials" (page 22)
- See "Special Application Belt Materials" (page 22)
- See "Friction factors" (page 26)

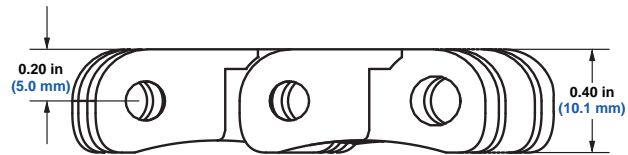

Belt Data

Belt Material	Standard Rod Material Ø 0.180 in (4.6 mm)	BS		Temperature Range (continuous)		W	
		Belt Strength		°F	°C	Belt Weight	
		lb/ft	kg/m			lb/ft ²	kg/m ²
Acetal	Nylon	907	1350	-50 to 200	-46 to 93	1.89	9.25